

## IR LED CAMERA

# TEC-C212QL

## 12 IR LED CAMERA



### - FEATURES -

- 1/3" SONY High-Resolution Super HAD CCD
- 540TV Lines Horizontal Resolution
- Excellent Low Light Sensitivity of 0.3Lux/F1.2
- LED On : 0Lux
- 12pcs IR LED for night vision
- Day & Night
- Auto White Balance
- Auto Gain control
- Visibility Range : 12~15mm
- Fixed Lens : 2.9mm

### Option

- Audio



### - DIMENSION -

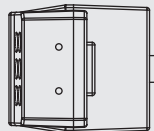
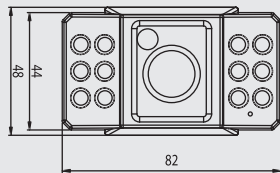
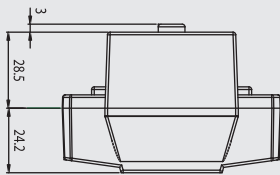

### - I-TYPE -



TEC-C212QLI

### - SPECIFICATIONS -

| TEC-C212QL            |   |                            |
|-----------------------|---|----------------------------|
| Signal Format         | NTSC  | PAL                        |
| Horizontal Resolution | 540 TV Lines  |                            |
| Image Sensor          | 1/3" SONY High-Resolution Super HAD CCD                 |                            |
| Effective Pixels      | 768(H) x 494(V)   | 752(H) x 582(V)            |
| Scanning System       | 2:1 Interlace   |                            |
| Synchronization       | Internal  |                            |
| Scanning Frequency    | 15.734 KHz(H), 59.94 Hz(V)                              | 15.625 KHz(H), 50.00 Hz(V) |
| Video Output          | CVBS : 1.0Vp-p / 75Ω                                    |                            |
| Min. Illumination     | Color : 0.3 Lux, B/W : 0.01Lux, LED On : 0Lux           |                            |
| Electronic Shutter    | 1/60 ~ 1/100,000 sec                                    | 1/50 ~ 1/100,000 sec       |
| IRIS Control          | MANUAL  |                            |
| Signal to Noise Ratio | 48 dB (AGC Off)   |                            |
| White Balance         | AUTO  |                            |
| Gain Control          | AUTO  |                            |
| Day & Night           | IR LED On   |                            |
| Gamma                 | 0.45  |                            |
| Lens                  | Fixed Lens : 2.9mm                                      |                            |
| LED Qty               | 12 pcs  |                            |
| Input Voltage         | DC 12V (±10%)   |                            |
| Power Consumption     | Max. 3.2W   |                            |
| Operating Temp / Hum  | Temperature : -10°C to +50°C / Humidity : 30% to 80% RH |                            |
| Storage Temp / Hum    | Temperature : -20°C to +60°C / Humidity : 20% to 90% RH |                            |
| Dimension             | 82(W) x 48(H) x 55.7(D)mm                               |                            |
| Weight                | Approx. 170g (W/O Bracket)                              |                            |
| Option                | I-Type, Audio   |                            |